

## LYELL BUSINESS CENTER

1029 Lyell Ave, Rochester, NY 14606



### ADAM BORRELL

Senior Leasing Executive

(585) 615-3593

[aborrell@buckprop.com](mailto:aborrell@buckprop.com)

### SQUARE FOOTAGE

14,400 SF

### ABOUT THE SPACE

Lyell Business Center is a brick and mortar flex building complex on a busy truck and commuter route near the City of Rochester and expressways. Manufacturing, warehouse, and office/showroom all fit comfortably here. This space offers plenty of storefront visibility, an expansive showroom, private restrooms, three private offices, one grade level door, and one dock.



BUCKINGHAM PROPERTIES

(585) 295-9500 | [www.buckprop.com](http://www.buckprop.com) | 259 Alexander Street, Rochester, NY



# LYELL BUSINESS CENTER

1029 Lyell Ave, Rochester, NY 14606

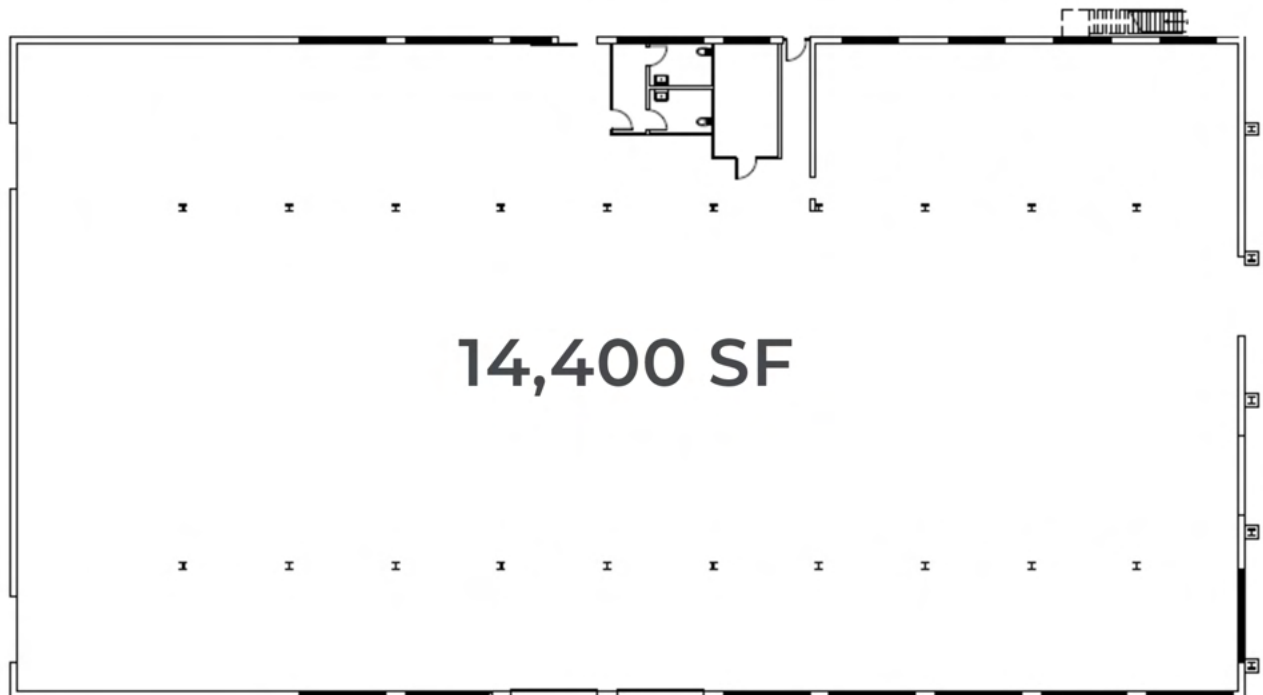

BUCKINGHAM PROPERTIES

(585) 295-9500 | [www.buckprop.com](http://www.buckprop.com) | 259 Alexander Street, Rochester, NY



## LYELL BUSINESS CENTER

961-1029 Lyell Ave, Rochester, NY 14606-1956



### ADAM BORRELL

Senior Leasing Executive

(585) 615-3593

[aborrell@buckprop.com](mailto:aborrell@buckprop.com)

### SQUARE FOOTAGE

3,554 SF

### ABOUT THE SPACE

Lyell Business Center is a brick and mortar flex building complex on a busy truck and commuter route near the City of Rochester and expressways. Manufacturing, warehouse, and office/showroom all fit comfortably here.



BUCKINGHAM PROPERTIES

(585) 295-9500 | [www.buckprop.com](http://www.buckprop.com) | 259 Alexander Street, Rochester, NY



# LYELL BUSINESS CENTER

961-1029 Lyell Ave, Rochester, NY 14606-1956



BUCKINGHAM PROPERTIES

(585) 295-9500 | [www.buckprop.com](http://www.buckprop.com) | 259 Alexander Street, Rochester, NY



## LYELL BUSINESS CENTER

961-1029 Lyell Ave, Rochester, NY 14606-1956



### ADAM BORRELL

Senior Leasing Executive

(585) 615-3593

[aborrell@buckprop.com](mailto:aborrell@buckprop.com)

### SQUARE FOOTAGE

2,678 SF

### ABOUT THE SPACE

Lyell Business Center is a brick and mortar flex building complex on a busy truck and commuter route near the City of Rochester and expressways. Manufacturing, warehouse, and office/showroom all fit comfortably here.



BUCKINGHAM PROPERTIES

(585) 295-9500 | [www.buckprop.com](http://www.buckprop.com) | 259 Alexander Street, Rochester, NY



# LYELL BUSINESS CENTER

961-1029 Lyell Ave, Rochester, NY 14606-1956



BUCKINGHAM PROPERTIES

(585) 295-9500 | [www.buckprop.com](http://www.buckprop.com) | 259 Alexander Street, Rochester, NY



## LYELL BUSINESS CENTER

961-1029 Lyell Ave, Rochester, NY 14606-1956



### ADAM BORRELL

Senior Leasing Executive

(585) 615-3593

[aborrell@buckprop.com](mailto:aborrell@buckprop.com)

### SQUARE FOOTAGE

2,400 SF

### ABOUT THE SPACE

Lyell Business Center is a brick and mortar flex building complex on a busy truck and commuter route near the City of Rochester and expressways. Manufacturing, warehouse, and office/showroom all fit comfortably here.



BUCKINGHAM PROPERTIES

(585) 295-9500 | [www.buckprop.com](http://www.buckprop.com) | 259 Alexander Street, Rochester, NY



# LYELL BUSINESS CENTER

961-1029 Lyell Ave, Rochester, NY 14606-1956



BUCKINGHAM PROPERTIES

(585) 295-9500 | [www.buckprop.com](http://www.buckprop.com) | 259 Alexander Street, Rochester, NY